

ORDINANCE No. 2019- 005
CITY OF ROMULUS
APPENDIX A – ZONING
AMENDMENT 1.244

An Ordinance to amend the Official Zoning Map of the City of Romulus by conditionally rezoning certain property from M-2, General Industrial to M-T, Industrial Transportation.

THE CITY OF ROMULUS ORDAINS:

SHORT TITLE: This Ordinance shall be known and cited as the Amended Zoning Ordinance.

SECTION 1: To conditionally rezone 35.55 acres of property at 37685 Van Born (Parcel ID #80-021-99-0002-701) from M-2, General Industrial District to M-T, Industrial Transportation.

LEGAL DESCRIPTION

06B2 C2 D2 E

PT OF THE NE 1/4 OF SEC 6 T3S R9E DESC AS BEG AT A CONCRETE MONUMENT IN BOX BEING 0.73 FT SOUTHERLY OF THE INTERSECTION OF THE NORTH-SOUTH 1/4 LINE OF FRACTIONAL SEC 6 AND THE N LINE OF SEC 6 TH N 00D 00M 53S E 0.73 FT TH N 89D 43M 15S E 124.80 FT ALONG TH N LINE OF SAID FRACTIONAL SEC 6 AND THE CENTERLINE OF VAN BORN ROAD (120 FT WIDE) TO THE S 1/4 COR OF SEC 31 T2S R9E TH N 89D 44M 54S 1195.51 FT ALONG SAID SEC LINE AND SAID CENTERLINE TH S 00D 02M 38S W 60 FT TO THE POB TH N 89D 44M 54S E 466.17 FT ALONG THE SOUTHERLY R OF W LINE OF SAID VAN BORN ROAD TH S 15D 59M 10S W 161.77 FT TH S 14D 33M 07S W 343.60 FT TH S 15D 00M 43S W 52.85 FT TH S 00D 03M 58S W 960.82 FT TH N 89D 44M 54S E 568 FT TH N 00D 03M 58S E 140 FT TH N 89D 44M 54S E 100 FT TH S 00D 03M 58S W 1155.36 FT ALONG THE W LINE OF THE E 1/4 OF THE E 1/2 OF THE NE 1/4 OF FRACTIONAL SEC 6 TO THE EAST - WEST 1/4 LINE OF SAID FRACTIONAL SEC 6 TH S 88D 39M 56S W 989.51 FT TH N 00D 02M 38S E 2533.39 FT ALONG THE W LINE OF THE E 1/2 OF THE NE 1/4 OF SAID FRACTIONAL SEC 6 TO THE SOUTHERLY R OF W LINE OF VAN BORN ROAD AND THE POB

35.55 ACRE

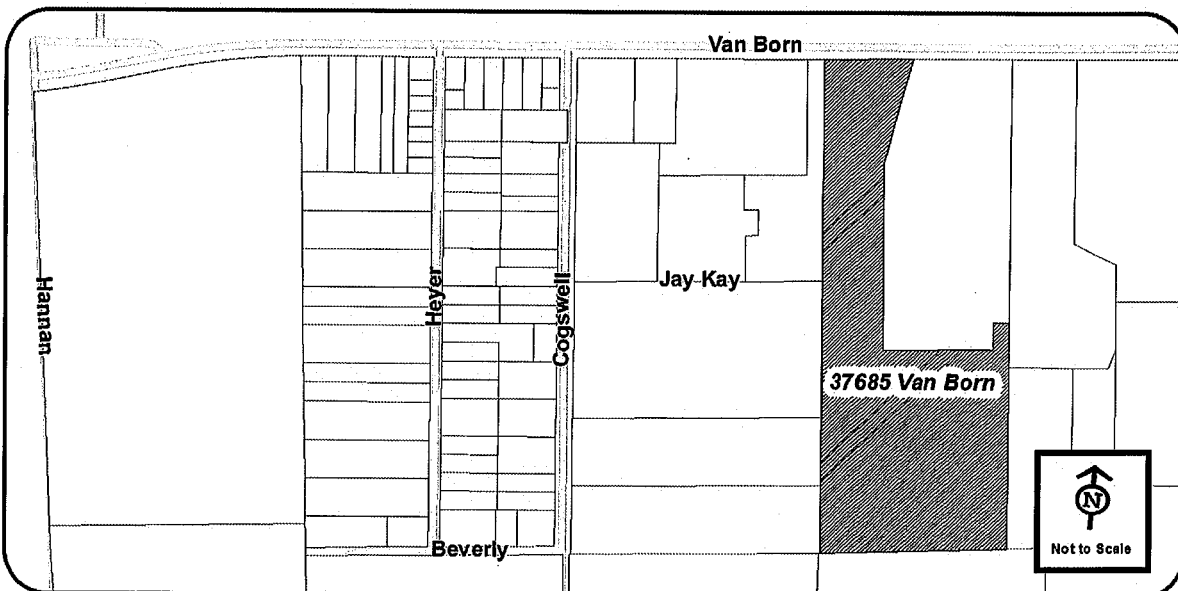

SECTION 2: Severability. Should any word, sentence, phrase or any portion of this ordinance be held in any manner invalid by any court of competent jurisdiction or by any state agency having authority to do so for any reason whatsoever, such holdings shall be construed and limited to such words, sentence, phrase, or any portion of the ordinance held to be so invalid and shall not be construed as effecting the validity of any of the remaining words, sentences, phrases or portions of this ordinance.

SECTION 3: Conflicting Ordinances. All prior existing ordinances adopted by the City of Romulus inconsistent or in conflict with the provisions of this ordinance are, to the extent of such conflict or inconsistency hereby expressly repealed.

SECTION 4: Effective Date. This ordinance shall take effect upon publication thereof in an official newspaper, which publication shall be made when the minutes passing the ordinance are published subject to revocation at will of the City of Romulus at any time.

ADOPTED, APPROVED AND PASSED by the City Council at the City of Romulus this 8th day of July, 2019.

LeRoy D. Burcroff, Mayor

Ellen L. Craig-Bragg, City Clerk

I hereby certify that the foregoing is a true copy of the Ordinance as passed by the City Council of the City of Romulus at a regular Council Meeting held in the City Council Chambers in said City on the 8th day of July, 2019.

Ellen L. Craig-Bragg, City Clerk

Introduced: July 1, 2019
Adopted: July 8, 2019
Published: August 1, 2019